

# SCREAMER



**aSCADA**  
product line

Integrated compact electronic siren

**SCREAMER** is a specialized electronic component in the modular **sound distribution, warning and evacuation system, aSCADA**. The main function of the **SCREAMER** component is an **integrated electronic siren**. The electronic module of **SCREAMER** component is placed directly in a durable aluminum alloy horn with a powerful pressure loudspeaker. This module integrates powerful electronic amplifier, digital audio signals memory and input interfaces to activate the playback of pre-recorded warning messages or broadcast live

reports. **SCREAMER** offers many ways to ensure required functionality – from a simple configuration to the sophisticated programming of required algorithms. It is possible to virtually store unlimited number of reports, clarify their priorities, interruptions, combinations and much more. **SCREAMER** is available in two different versions, small and large horn. The small horn has an acoustic directivity pattern close to the circle shape with lower acoustic pressure, while the large horn has an elliptical acoustic directivity pattern and higher acoustic pressure.



„The main function of the device is broadcasting voice messages or acoustic warning signals based on a stimulus from the environment.“

#### SCREAMER can broadcast:

- voice messages and signals from the internal memory (SD card),
- live voice messages from the external microphone,
- audio signals from various external sources (radio, cell phones, etc.).

#### The messages are activated by:

- signals fed to one of the four binary inputs
- RS232/RS485 interface by other systems
- interface through aBUS and other devices from the aSCADA system
- wireless technology XBee (requires additional module XBee)
- line interface via Ethernet (requires TCP/IP module)
- WiFi interface (requires TCP/IP module)
- GPRS interface (requires TCP/IP + GPRS module)

#### Technical specifications:

Max. output: 70 W RMS (electronically adjustable)  
Max. acoustic pressure: 125,5 dB(A)/1m big horn, 124 dB(A)/1m small horn  
Voltage: 11.5 - 30 V =

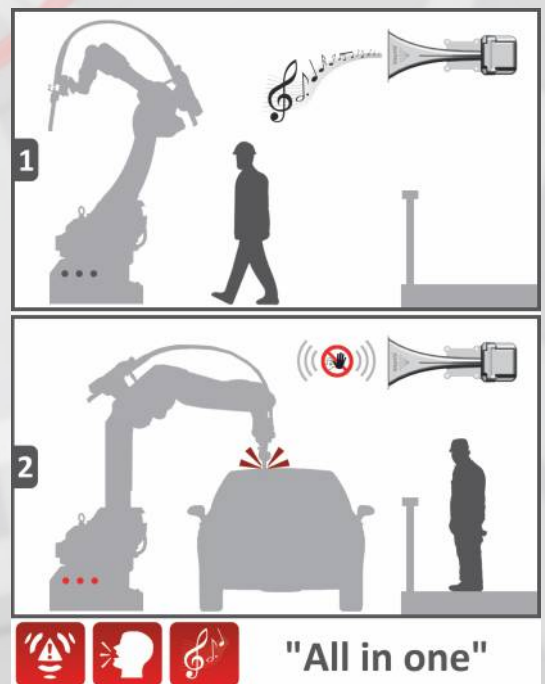

# SCREAMER



**ASCADA**  
product line

Auxiliary accessories

## Remote control



### Basic technical data:

**Power supply:** LiPol 3.7 V battery, or external 5 V source

**Dimensions (L x W x H):** 15 x 9 x 3 cm

**Operating temperature range:** -40°C to +85°C

**SCREAMER** integrated electronic siren is supplied with optional accessories like remote controls able to control the siren via all additional wireless interfaces as well as via the RS 485 standard interface. They are manufactured in two versions:



Standard with four buttons



Professional with a display and an encoder

Remote controls can be equipped with the RfId cards reader for operating staff identification and provision for activation only by authorised persons. Both types have an inbuilt microphone and also enable broadcasting of live announcements.

## Additional communication interfaces

**SCREAMER** integrated electronic siren can be typically controlled via four binary inputs and the RS 485 interface. These standard options can be supplemented with more communication interfaces using additional modules:

- wireless WiFi,
- wireless XBee,
- line Ethernet,
- wireless GPRS.



These communication equipments enable to control the **SCREAMER** integrated electronic siren from an entity's own facilities, or from third parties facilities: for example via common computer WiFi network or structured cabling.

## Operator's Control Panel



Operator's Control Panel can be used in development of complex systems requiring advanced administration and extended functions. The desk primarily serves for interaction between the system and the operating staff and includes a possibility of zone formation, system modules automatic testing, use of inbuilt FM radio, or integration with other systems and equipments.